

SUPPORT OUR PRE-SCHOOL

The Facts About Our Proposed New Build

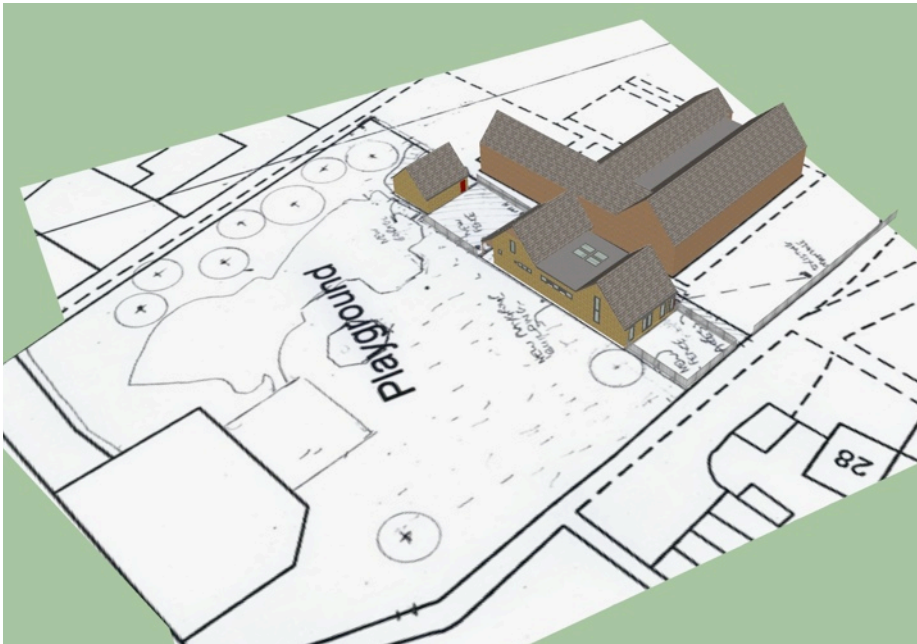

Stanford Pre-school is one of just a few remaining pack-away pre-schools left within Oxfordshire.

Others in the area have applied for and received a Early Years Capital Grant and are on the way to building dedicated settings, with the support of their communities.

Stanford Pre-school is currently heavily over-subscribed.

As it stands the village pre-school is over-subscribed and many children who have the right to funded sessions cannot be accommodated. Having our own dedicated building would solve this issue.

Stanford Pre-school is 40 years old this year.

It has run successfully from the village hall in this time and we would like to thank the Village Hall Committee for their support.

Without the new building, the future of Stanford Pre-school could be in jeopardy.

Strict criteria needs to be met in running early years settings and in the delivery of the Early Years Foundation Stage. OFSTED recently submitted a glowing report for our pre-school and the offering they provide, and the staff work hard to overcome the many challenges faced as a pack-away setting. However, future changes in government legislation could mean that our



pre-school as it currently stands would struggle more and more to meet the strict standards required. Having our own dedicated building would avoid these problems, thus securing the future of our pre-school for generations to come.

The Early Years Capital Grant is our only chance at having our own dedicated building.

This is a 'once in a lifetime' opportunity and when the money has been allocated there will not be another chance. We need your support, however, as the grant will only be awarded if it is considered feasible for the project to be completed by 31st March 2011.

Where should the new pre-school be built?

Over the past 6 months, a large number of options have been explored and every avenue but one has been exhausted. In

particular, the local school does not have enough land for a additional pre-school building, and the Millennium Green and the land within the new estate is protected and cannot be built upon. Our only remaining option, therefore, is the land around the village hall.

One solution would have been to extend the village hall in some way, maybe by adding onto the land adjacent to the car park, but unfortunately these options were not acceptable to the Village Hall Committee. The building being proposed would not take away the park or play facilities which are already in place, but instead would be built on an area of the park that is currently hardly used, an area that makes up just 15% of the current park.

We are not trying to take the play area away but to protect the village pre-school for the future.

If you wish to make any comments on the plans, or register your support, then please visit:

<http://planning.whitehorsedc.gov.uk/publicaccess/>

Click on "planning" on the left hand side, and then "application search".

Enter 10/00018/FUL in the box entitled "Computer Application Case Reference".